

2-3/8" TO 3-1/2"
O.D. PIPE
(ORDERED SEPARATELY)

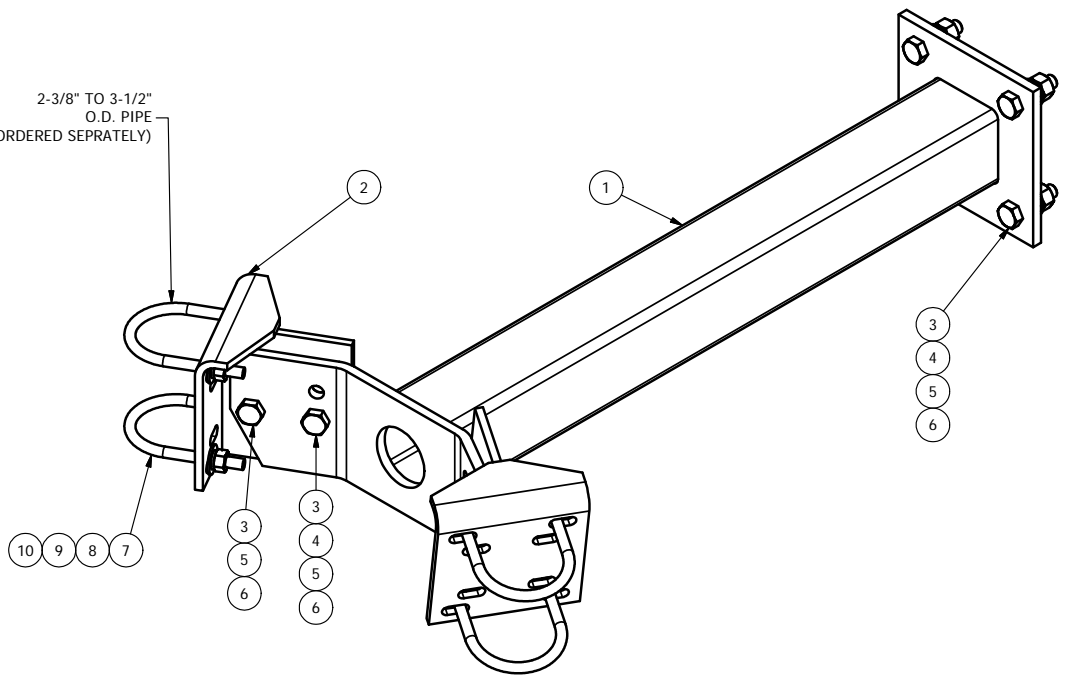

PARTS LIST						
ITEM	QTY	PART NO.	PART DESCRIPTION	LENGTH	UNIT WT.	NET WT.
1	1	X-99043	SA2-24 MAIN STANDOFF BRACKET		48.94	48.94
2	2	X-ATB	PIPE ATTACHMENT BRACKET		10.68	21.37
3	8	A582112	5/8" x 2-1/2" HDG A325 HEX BOLT	2.5 in.	0.33	2.67
4	6	A58FW	5/8" HDG A325 FLATWASHER		0.03	0.20
5	8	G58LW	5/8" HDG LOCKWASHER		0.03	0.21
6	8	A58NUT	5/8" HDG A325 HEX NUT		0.13	1.04
7	4	X-UB1358	1/2" X 3-5/8" X 5-1/2" X 3" U-BOLT (HDG.)		0.77	3.09
7	4	X-UB1300	1/2" X 3" X 5" X 2" UBOLT (HDG.)		0.70	2.80
7	4	X-UB1212	1/2" X 2-1/2" X 4-1/2" X 2" UBOLT (HDG.)		0.63	2.52
8	8	G12FW	1/2" HDG USS FLATWASHER		0.03	0.27
9	8	G12LW	1/2" HDG LOCKWASHER		0.01	0.11
10	8	G12NUT	1/2" HDG HEAVY 2H HEX NUT		0.07	0.57
					TOTAL WT. #	83.21

TOLERANCE NOTE
 TOLERANCES ON DIMENSIONS, UNLESS OTHERWISE NOTED ARE:
 SAWED, SHEARED AND GAS CUT EDGES ($\pm 0.030"$)
 DRILLED AND GAS CUT HOLES ($\pm 0.030"$) - NO CONING OF HOLES
 LASER CUT EDGES AND HOLES ($\pm 0.010"$) - NO CONING OF HOLES
 BENDS ARE $\pm 1/2$ DEGREE - ALL OTHER MACHINING ($\pm 0.030"$)
 ALL OTHER ASSEMBLY ($\pm 0.060"$)

DESCRIPTION
**STANDOFF ARM
 FOR TWO
 ANTENNA PIPES**

SITE PRO 1
 A valmont COMPANY
 Engineering Support Team:
 1-888-753-7446
 Locations:
 New York, NY
 Atlanta, GA
 Los Angeles, CA
 Plymouth, IN
 Salem, OR
 Dallas, TX

DRAWN BY
CEK 11/15/2010
 ENG. APPROVAL

CPD NO.
4779

DRAWING USAGE
CUSTOMER
 CHECKED BY
BMC 1/6/2012

PART NO.
SA2-24

DWG. NO.
SA2-24

REV	DESCRIPTION OF REVISIONS	CPD	BY	DATE
A	REPLACED X-210746 WITH X-ATB	4779	CEK	1/5/2012
REVISION HISTORY				

PROPRIETARY NOTE
 THE DATA AND TECHNIQUES CONTAINED IN THIS DRAWING ARE PROPRIETARY INFORMATION OF VALMONT INDUSTRIES AND CONSIDERED A TRADE SECRET. ANY USE OR DISCLOSURE WITHOUT THE CONSENT OF VALMONT INDUSTRIES IS STRICTLY PROHIBITED.