

PARTS LIST						
ITEM	QTY	PART NO.	PART DESCRIPTION	LENGTH	UNIT WT.	NET WT.
1	3	L33375-3	SMART CORNER BRACE	36 in	21.38	64.15
2	3	CBP-L	CORNER BENT PLATE - LEFT	12 3/8 in	9.37	28.10
3	3	CBP-R	CORNER BENT PLATE - RIGHT	12 3/8 in	9.37	28.10
4	3	PST2875-12.5	SUPPORT RAIL PIPE	150 in	76.94	230.81
5	12	PL375-857	CROSSOVER PLATE	8 1/2 in	6.23	74.71
6	60	X-UB5300	5/8" X 3" X 5-1/4" X 2-1/2" U-BOLT (HDG.)		1.15	68.97
7	120	G58FW	5/8" HDG USS FLATWASHER		0.07	8.46
8	144	G58LW	5/8" HDG LOCKWASHER		0.03	3.76
9	144	G58NUT	5/8" HDG HEAVY 2H HEX NUT		0.13	18.70
10	24	A5802	5/8" x 2" HDG A325 HEX BOLT		0.27	6.52
TOTAL WT. #						532.27

2-7/8" OD ANTENNA MAST PIPE
(ORDERED SEPARATELY)

FIELD CUT TO FIT IF NECESSARY
AND THEN COLD GALVANIZE.

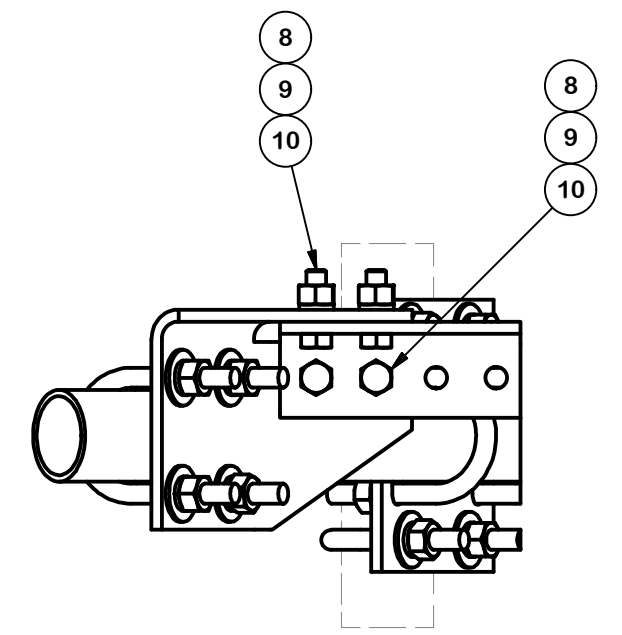
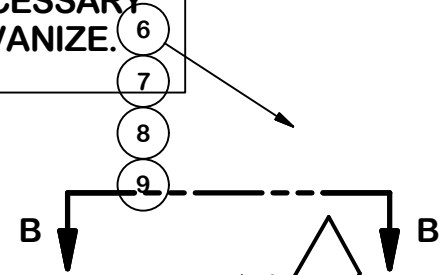

VIEW B-B

DETAIL A

Valmont Site Pro 1
Lori.Espinosa@valmont.com
(631) 715-3045
www.sitepro1.com

TOLERANCE NOTES
 TOLERANCES ON DIMENSIONS, UNLESS OTHERWISE NOTED ARE:
 SAWED, SHEARED AND GAS CUT EDGES ($\pm 0.030"$)
 DRILLED AND GAS CUT HOLES ($\pm 0.030"$) - NO CONING OF HOLES
 LASER CUT EDGES AND HOLES ($\pm 0.010"$) - NO CONING OF HOLES
 BENDS ARE $\pm 1/2$ DEGREE
 ALL OTHER MACHINING ($\pm 0.030"$)
 ALL OTHER ASSEMBLY ($\pm 0.060"$)

PROPRIETARY NOTE:
THE DATA AND TECHNIQUES CONTAINED IN THIS DRAWING ARE PROPRIETARY INFORMATION OF VALMONT INDUSTRIES AND CONSIDERED A TRADE SECRET. ANY USE OR DISCLOSURE WITHOUT THE CONSENT OF VALMONT INDUSTRIES IS STRICTLY PROHIBITED.

DESCRIPTION
SUPPORT RAIL KIT

CPD NO.	DRAWN BY	ENG. APPROVAL
	JFS 3/18/2020	5/10/2020
CLASS	DRAWING USAGE	CHECKED BY
87 02	CUSTOMER	BMC 5/10/2020

SITE PRO 1
 A valmont COMPANY

Engineering Support Team:
1-888-753-7446

Locations:
New York, NY
Atlanta, GA
Los Angeles, CA
Plymouth, IN
Salem, OR
Dallas, TX

PART NO.	VZWSMART-PLK1
DWG. NO.	VZWSMART-PLK1