

2-3/8" O.D. PIPE
(ORDERED SEPARATELY)

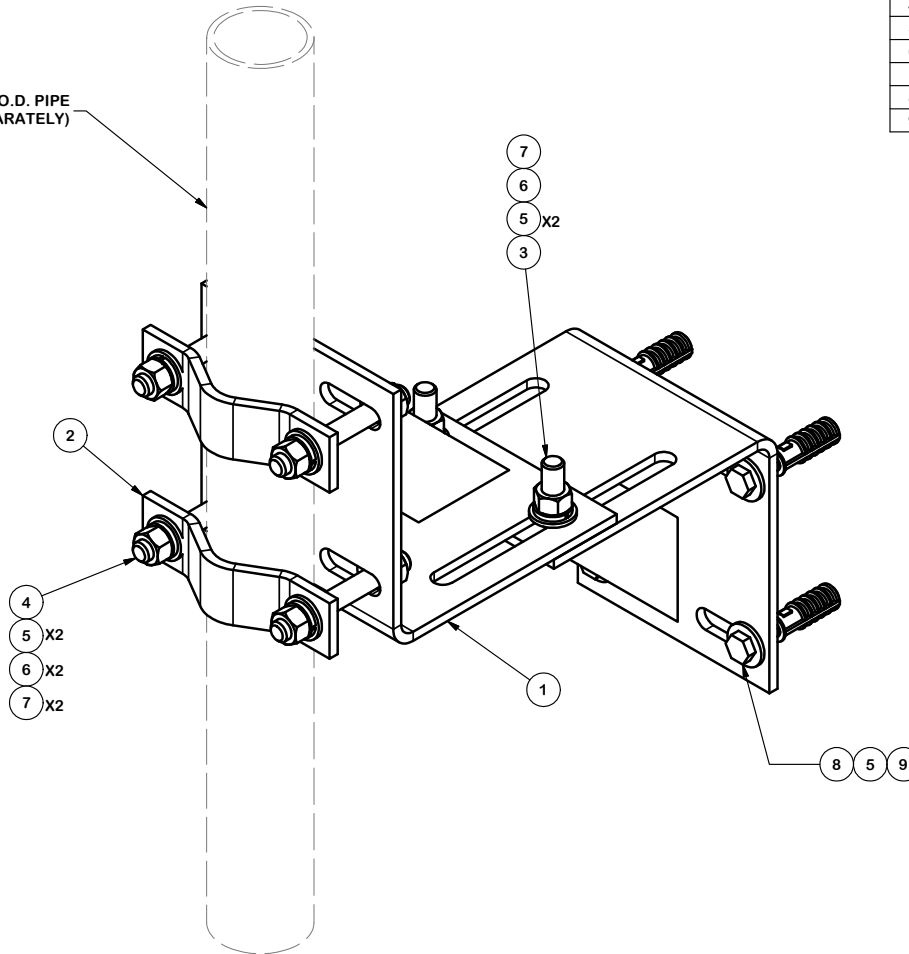

| PARTS LIST | | | | | |
|-------------|-----|------------------------------------|--------|----------|---------|
| ITEM | QTY | PART DESCRIPTION | LENGTH | UNIT WT. | NET WT. |
| 1 | 2 | WALL MOUNT BRACKET | | 6.13 | 12.26 |
| 2 | 2 | 1.5" - 3.5" O.D. CLAMP HALF | | 0.61 | 1.22 |
| 3 | 2 | 1/2" X 2" GALV BOLT | | 0.16 | 0.32 |
| 4 | 4 | 1/2"-13 UNC X 4" GALV THREADED ROD | | 0.22 | 0.89 |
| 5 | 16 | 1/2" GALV FLAT WASHER | | 0.02 | 0.30 |
| 6 | 10 | 1/2" GALV LOCK WASHER | | 0.01 | 0.13 |
| 7 | 10 | 1/2"-13 UNC GALV HEX NUT | | 0.04 | 0.43 |
| 8 | 4 | 1/2" X 2-1/2" GALV LAG SCREW | | 0.07 | 0.27 |
| 9 | 4 | 1/2" SHORT GALV LAG SHIELD | | 0.07 | 0.26 |
| TOTAL WT. # | | | | 16.09 | |

TOLERANCE NOTES

TOLERANCES ON DIMENSIONS, UNLESS OTHERWISE NOTED ARE:
 SAWED, SHEARED AND GAS CUT EDGES ($\pm 0.030"$)
 DRILLED AND GAS CUT HOLES ($\pm 0.030"$) - NO CONING OF HOLES
 LASER CUT EDGES AND HOLES ($\pm 0.010"$) - NO CONING OF HOLES
 BENDS ARE $\pm 1/2$ DEGREE
 ALL OTHER MACHINING ($\pm 0.030"$)
 ALL OTHER ASSEMBLY ($\pm 0.060"$)

PROPRIETARY NOTE:
 THE DATA AND TECHNIQUES CONTAINED IN THIS DRAWING ARE PROPRIETARY INFORMATION OF VALMONT INDUSTRIES AND CONSIDERED A TRADE SECRET. ANY USE OR DISCLOSURE WITHOUT THE CONSENT OF VALMONT INDUSTRIES IS STRICTLY PROHIBITED.

DESCRIPTION
 UNIVERSAL ADJUSTABLE
 WALL MOUNT,
 7" - 12" STANDOFF

| | | |
|-------------|---------------------------|---------------------------|
| CPD NO. | DRAWN BY CEK 1/20/2015 | ENG. APPROVAL |
| CLASS 81 | SUB 01 | DRAWING USAGE CUSTOMER |
| | CHECKED BY BMC | 2/3/2015 |



Engineering
 Support Team:
 1-888-753-7446

Locations:
 New York, NY
 Atlanta, GA
 Los Angeles, CA
 Plymouth, IN
 Salem, OR
 Dallas, TX

| | |
|----------|---------|
| PART NO. | WMU-12S |
| DWG. NO. | WMU-12S |